

An architectural rendering of a modern apartment complex at dusk. The scene shows a long, narrow courtyard flanked by multi-story brick buildings. The sky is a mix of deep blue and orange, with some clouds. The buildings have large windows, some of which are illuminated from within. In the foreground, there are landscaped areas with trees, bushes, and flowers. A few people are visible: two women jogging on the left, a person walking on the right, and a person on a bicycle in the distance. The overall atmosphere is bright and inviting.

THE WAYPOINT

RENTAL LIVING YOUR WAY
1, 2 & 3 BEDROOM APARTMENTS
IN MAIDENHEAD



CONTENTS

Discover life in rhythm	03
Moments from the River. Minutes from the City	04
Connected to it all	05
Forward-thinking design	06
Navigate between the city's pace and the sanctuary of home	07
Sustainability	08
Lifestyle and community	10
Everything you need, right at home	11
Step inside The Waypoint	12

DISCOVER LIFE IN RHYTHM

The Waypoint is more than a place to live — it's the balance you've been looking for. Here, thoughtfully crafted homes and community spaces bring together design, comfort, and effortless connection, creating an environment that truly moves with your lifestyle.

Whether you're unwinding after a day in the city or hosting friends in your beautifully designed home, The Waypoint offers a rental experience built around you. Every detail, from the sleek interiors to the shared spaces, has been considered with one goal in mind: to give you more.

Perfectly positioned between London and the River Thames, The Waypoint gives you the best of both worlds. With the Elizabeth Line just moments from your door, the capital is within easy reach — yet the moment you step outside, you're met with green parks, boutique cafés, and peaceful riverside walkways.

MOMENTS FROM THE RIVER. MINUTES FROM THE CITY.



Maidenhead offers a rare blend of connectivity and calm. This is where the energy of city life meets the restorative pace of riverside living — where every journey feels purposeful and every return feels like coming home.

CONNECTED TO IT ALL



Well connected by rail, underground and road, Maidenhead makes travel simple, whether you're heading into the city or exploring further afield. Plus, with private underground residents' parking on-site, every journey starts and ends with convenience.

BY TRAIN



BY CAR



Distances and travel times taken from google.co.uk/maps and nationalrail.co.uk and are approximate only. Train connections starting from Maidenhead Station, car travel times taken from SL6 8AW. Fastest train journey and car route.

SITEPLAN

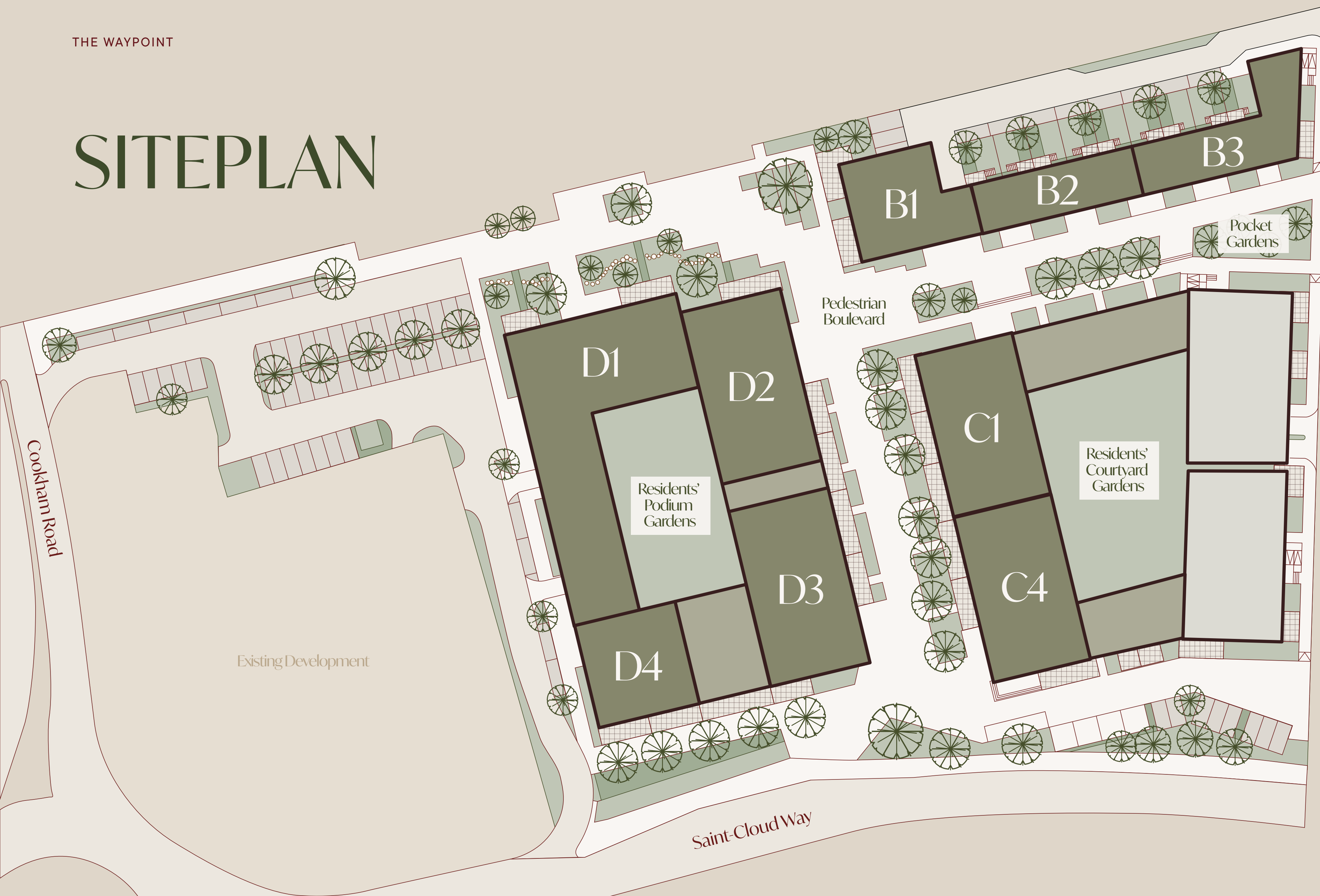

- B1 - BEACON HOUSE
- B2 - TOWNHOUSES
- B3 - COMPASS HOUSE

- C1 - ZENITH HOUSE
- C4 - ORION HOUSE

- D1 - PORT HOUSE
- D2 - ATLAS HOUSE
- D3 - HORIZON HOUSE
- D4 - VANTAGE HOUSE

NAVIGATE BETWEEN THE CITY'S PACE AND THE SANCTUARY OF HOME

Living at The Waypoint means choosing rental without compromise. It's a place where you can enjoy the quality, design and sense of community you'd expect from ownership, while staying connected to what's here today and everything still to come. A lifestyle that feels both established and full of possibility, on your terms.

Ongoing regeneration is reshaping the town centre into a vibrant, contemporary destination, where thoughtfully designed public spaces, new retail, and places to dine and unwind are bringing fresh life to the area.



BUILT-IN BALANCE

Step beyond your door and experience the perfect contrast. One moment, you're immersed in the energy and opportunity of the city; the next, you're surrounded by open skies, riverside paths and pockets of green

RIVER TRAILS

In just moments, you can step out and join a network of scenic trails that wind gently along the water, offering space to slow down, breathe deeply, and reconnect with the outdoors.



FORWARD-THINKING DESIGN

AT THE WAYPOINT, ENVIRONMENTALLY CONSCIOUS DESIGN DOESN'T MEAN SACRIFICING STYLE OR COMFORT. INSTEAD, IT'S SEAMLESSLY INTEGRATED.



Today's homes are designed with tomorrow in mind. Modern building standards place sustainability at their core, shaping spaces that are not only more energy efficient, but more comfortable to live in day to day.

Homes and spaces that support lower energy consumption, potentially reducing running costs, and contributing to a more modern way of renting, all without disrupting the look and feel of beautifully crafted interiors.





LIFESTYLE AND COMMUNITY

LIFE AT THE WAYPOINT IS ABOUT MORE THAN WHERE YOU LIVE, IT'S ABOUT HOW YOU FEEL, EVERY DAY.



From everyday moments to weekend plans, life here unfolds with a steady, comfortable rhythm. With green spaces, local cafés, and riverside walks all close at hand, there's always an opportunity to unwind, explore, or simply enjoy the pace of where you are.



Thoughtfully designed spaces make it easy to connect when you want to, and just as easy to take a step back. Whether it's a familiar face on your morning routine or time spent enjoying the surroundings with friends, there's a quiet sense of belonging that grows naturally over time, without ever feeling imposed.





EVERYTHING YOU NEED, RIGHT AT HOME

LIFE AT THE WAYPOINT EXTENDS WELL BEYOND YOUR FRONT DOOR. A CAREFULLY CURATED COLLECTION OF RESIDENT SPACES HAS BEEN DESIGNED TO COMPLEMENT EVERY ASPECT OF YOUR DAILY RHYTHM — WHETHER YOU'RE WORKING, WORKING OUT, OR SIMPLY WINDING DOWN.



From focused mornings in the coworking space to relaxed evenings in the residents' lounge, every amenity has been considered to give you more from life at home. Host in style with the club suite and event space, or unwind in the TV lounge — the choice is always yours. Step outside to the roof terrace for elevated views and open-air moments, or retreat to the courtyard gardens for a quieter escape surrounded by greenery.

You've found the balance between the energy of the city and the peace of home. You've found the community, the space, and the lifestyle. All that's left is to make it yours.

STEP INSIDE THE WAYPOINT



CRAFTED FOR COMFORT AND BUILT FOR BALANCE, EVERY HOME AT THE WAYPOINT EMBODIES QUIET LUXURY. EXPECT SLEEK INTERIORS, ELEGANT FINISHES, AND OPEN-PLAN DESIGN THAT MOVES EFFORTLESSLY WITH YOUR LIFESTYLE.

From the moment morning light fills your kitchen to the calm of an evening in, each space has been designed to reflect the way you truly live. These are homes that move with you, intuitively supporting your everyday.



Open-plan living areas flow naturally into private spaces, offering flexibility without compromise. Quality finishes and considered layouts make every home feel both refined and genuinely liveable — the kind of space you'll look forward to returning to, every single day.





RENTAL LIVING YOUR WAY

The Waypoint
2 Ermine Way
Maidenhead, SL6 8TH

READY TO RENT?

info@thewaypoint-maidenhead.co.uk
0330 236 9813

JOIN THE COMMUNITY

[@waypoint_maidenhead](https://www.instagram.com/waypoint_maidenhead)